

## Alphacool ES U-shape RAM Water Cooler 8-Bay Set

Alphacool article number: 17646



### Quick Info

The Alphacool ES U-shape RAM water cooler has been specifically designed to meet the high demands of powerful memory modules in server and workstation systems. Up to 8 RAM modules can be efficiently cooled with the U-shaped water cooler. Its flat design and versatile connection options make it easy to install in almost any server or workstation case.

- Reliable and effective RAM cooling
- Coverage of up to 8 RAM slots
- Connections in various directions

### Scope of delivery

1x ES RAM Cooler

16x Copper sheet

16x 114x21x0,5mm Pad

8x 114x21x1,5mm Pad

1x Plug tool

2x G1/4 Plug

1x RAM Tool

## Technical data

Dimensions (L x W x H)	185,26 x 62,46 x 21,50mm
Material	Copper
Weight (water cooler solo)	240g
Total weight (with RAM cooling plates)	530g
Covered RAM Slots	Up to 8
Gap between cooling channels	5,47mm
Pressure tested	0,8 bar
Connections	2x G1/4" In   2x G1/4" Out
Color	black

## Download links

Manual	<a href="#">17646_Alphacool_ES_U-shape_RAM_Water_Cooler_8-Bay_Set_Manual.pdf</a>
Product pictures	<a href="#">17646_Alphacool_ES_U-shape_RAM_Water_Cooler_8-Bay_Set_pics.zip</a>

## Packaging dimensions per unit

L x W x H	220 x 145 x 35 mm
Weight	620 g

## Other data

Certificates	CE, FC, RoHS
EAN	4250197176460
Customs code	84195080900
Guarantee	2 years

## Article text

The Alphacool ES U-shape RAM water cooler has been specifically designed to meet the high demands of powerful memory modules in server and workstation systems. Up to 8 RAM modules can be efficiently cooled with the U-shaped water cooler. Its flat design and versatile connection options make it easy to install in almost any server or workstation case.

### Reliable Cooling Performance

Modern RAM modules are becoming more powerful, generating increasing amounts of waste heat. To avoid loss of performance, reliable cooling is essential. This cooler meets that requirement. As is usual with Alphacool products, this water cooler is made entirely of copper to ensure maximum cooling performance.

### Easy Installation

Installation has been made as simple as possible. The RAM modules are enclosed by two nickel-plated copper sheet plates and installed on the motherboard. Then, the water cooler is routed over the RAM modules. The input and output connections to the front and sides allow for flexible integration into the water cooling loop.

**Note:** This cooler is only compatible with single-row RAM modules, see image or manual.

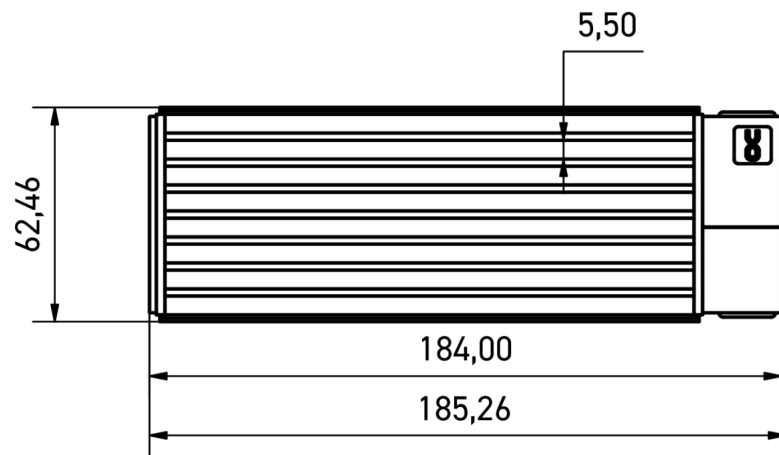
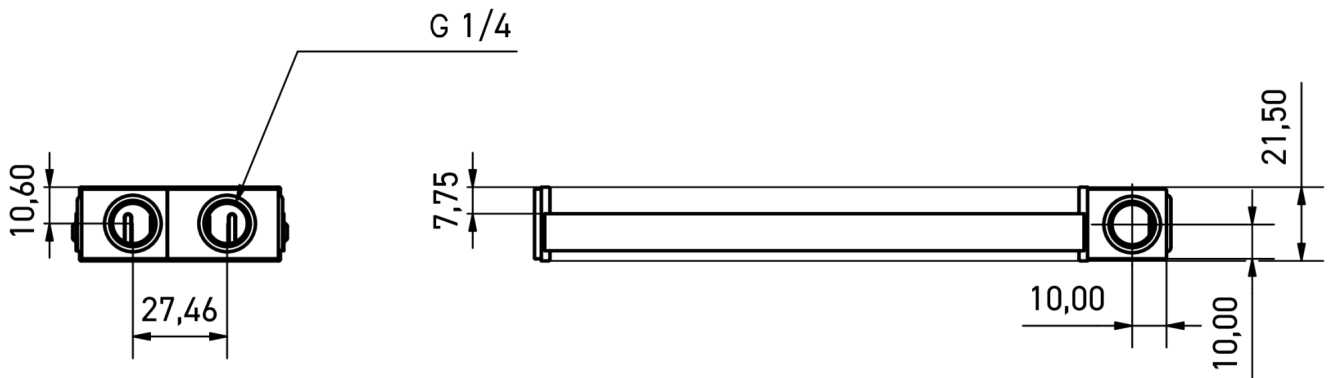

General tolerance:  $\pm 0,25$ mm  
Dimension in millimeter